

# INSTRUCTION MANUAL **MRAY LECTURE**

## 1. OPEN MRAY

Open the URL provided to you in your browser.

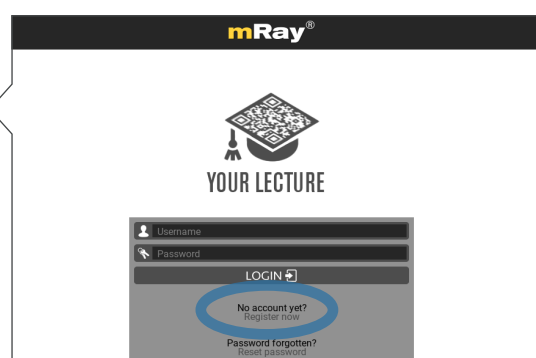

## 2. FIRST-TIME REGISTRATION

- (1) Click on "Register now" and enter your email address, your name, and a password of your choice.
- (2) Check the box for "Accept Terms of Use" and then click "Register".
- (3) Follow the link sent to your email to activate your account, and then log in.



## 3. UPLOADING IMAGES

Upload your **anonymized** data by clicking the plus button at the bottom right corner of your screen to select files.

Alternatively, you can drag and drop your files into the application.

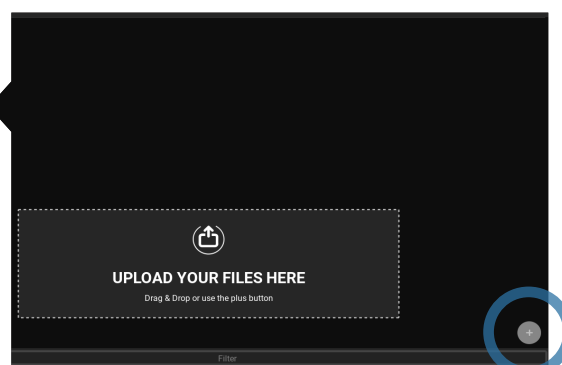

## 5. SHARING IMAGES

- (1) Click the share icon next to the uploaded images or study.
- (2) Select "mRay web link".
- (3) Activate the "seminar link for teaching purpose" option.  
Make sure the link is still active at the time of your presentation. You can adjust the expiration time under "Link expires after". Then click "Next."
- (4) Enter your email address and click "Send Link".
- (5) You will receive an email containing an QR code.

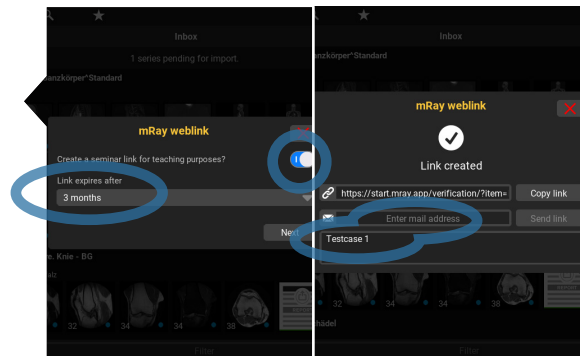
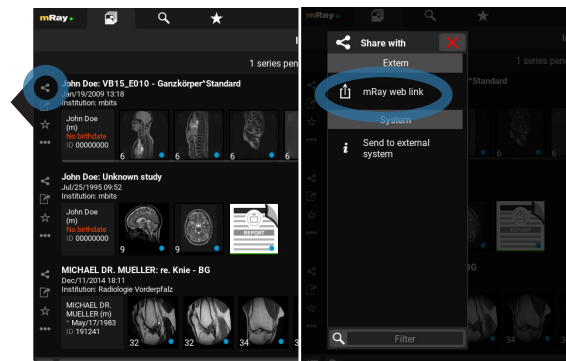

## 6. USE IN PRESENTATION

- (1) Copy the QR code from the email you received.  
*If you don't see the email, please check your spam folder.*
- (2) Paste the QR code into your presentation slide.



## 8. LIVE DEMO

During your presentation, participants can scan the QR code to access the shared study. They can view the images directly on their smartphones or tablets. Participants can also interact with the study, for example by adding annotations or using other available tools — making the live demo more dynamic and engaging.

